

# 12 Mile Paving Project Road Closed from Medina Blvd to Eastern City Limit

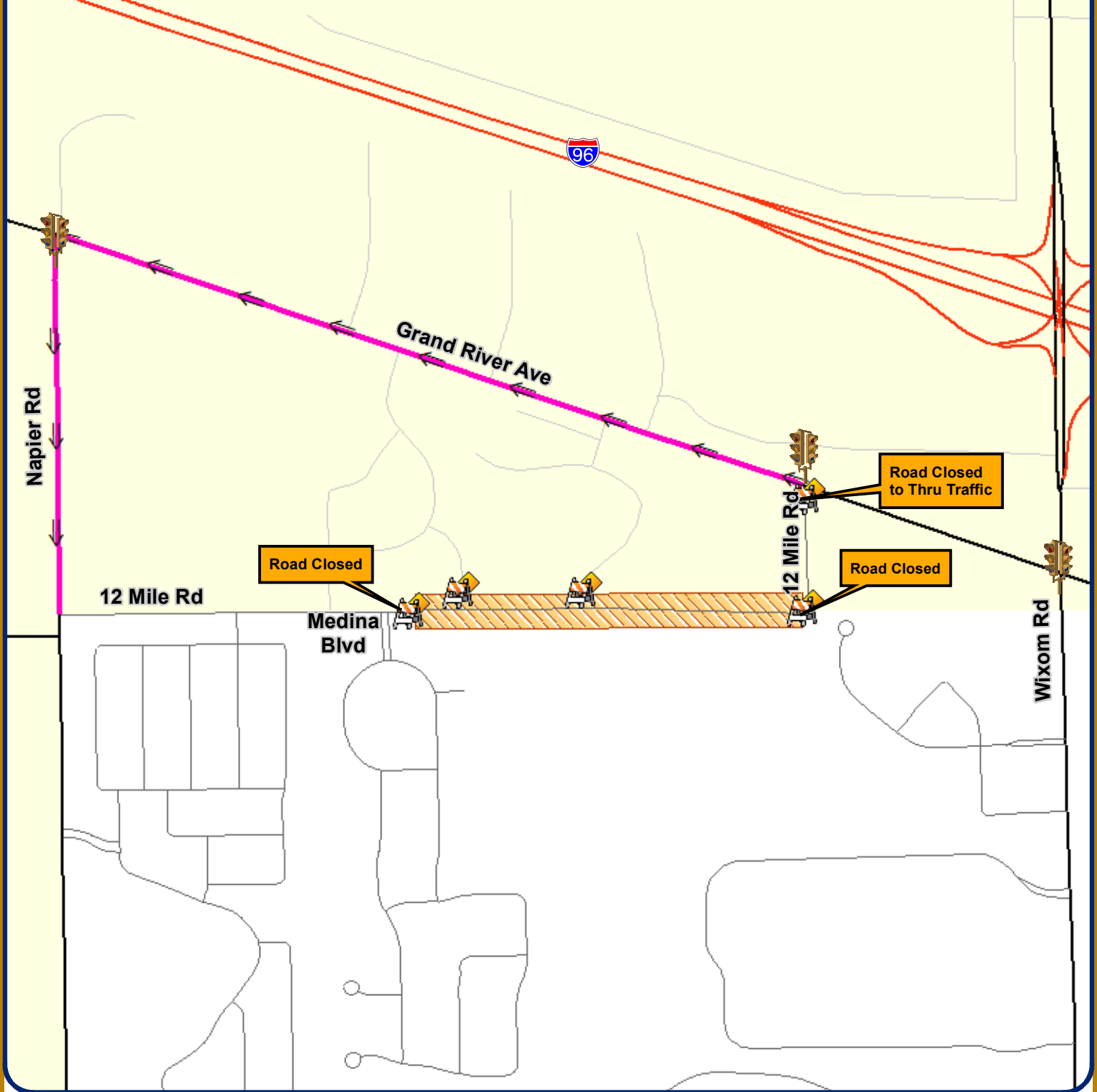

Map Author: Keri Blough  
 Date: September 2, 2022  
 Project: 12 Mile Rd Detour  
 Version #: 1.1

Amended By:  
 Date:  
 Department:

**MAP INTERPRETATION NOTICE**  
 Map information depicted is not intended to replace or substitute for any official or primary source. This map was intended to meet National Map Accuracy Standards and use the most recent, accurate sources available to the people of the City of Novi.  
 Boundary measurements and area calculations are approximate and should not be construed as survey measurements performed by a licensed Michigan Surveyor as defined in Michigan Public Act 132 of 1970 as amended. Please contact the City GIS Manager to confirm source and accuracy information related to this map.

Twelve Mile Rd from Medina Blvd to Novi City Limit will be **closed to all traffic** during the duration of this project.

**Designated detour:** Grand River Ave to Napier Rd and vice versa,

**Map Legend**

-  Road Closure
-  Designated Detour
-  Road CLOSED



## City of Novi

Engineering Division  
 Department of Public Works  
 26300 Lee BeGole Drive  
 Novi, MI 48375  
[cityofnovi.org](http://cityofnovi.org)

