

Welcome

Novi Dog Park

City Council Presentation

Monday, February 3, 2014



Project Management Team

- **Ben Croy – Engineering**
- **Brian Coburn – Engineering**
- **Tracie Ringle – Community Relations**
- **Wendy DuVall – PRCS**
- **Ayane Grubbs – Information Technology**
- **OHM Advisors – Design**

Novi Dog Park

- **Allow dogs to exercise and socialize safely**
- **Promotes responsible dog ownership**
- **Provides an outlet for dog owners to socialize**
- **Makes for a better community by promoting public health and safety**

Dog Park Location

42390 Nick Lidstrom Drive



PROJECT LOCATION

Amenities

- Double gated entry
- Key fob access system
- Bottle Filler/ Pet fountain
- Benches
- Large dog area (2.16 acres)
- Small/timid dog area (.75 acres)
- Parking



Novi Dog Park



Novi Dog Park

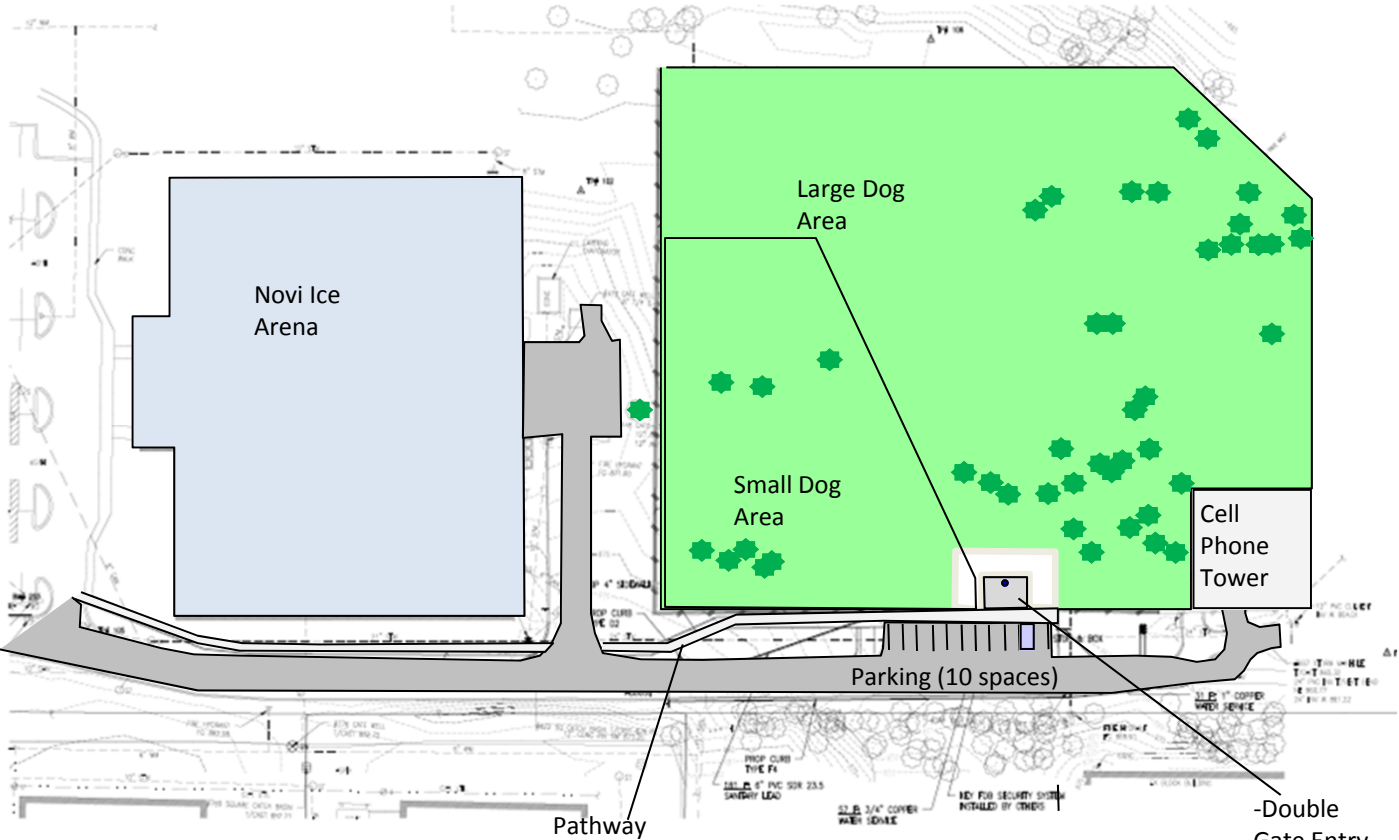

- Double Gate Entry System
- Benches
- Bottle Filler/Pet fountain



Budget

Item	Cost
Design and Engineering	\$13,000
Construction Cost	\$221,500
Site Amenities/ Signage	\$15,500
Total Project Cost	\$250,000



Tentative Schedule

February 2014

- Planning Commission
- Advertise Project for Bidding

March 2014

- Construction Award

April 2014

- Notice to Proceed

Spring /Summer

- Construction & Turf Establishment

Fall 2014

- Grand Opening





Questions?

