



COMMUNITY DEVELOPMENT DEPARTMENT

45175 Ten Mile Road
Novi, MI 48375
(248) 347-0415 Phone
(248) 735-5600 Facsimile
www.cityofnovi.org

ZONING BOARD OF APPEALS STAFF REPORT

FOR: City of Novi Zoning Board of Appeals **ZONING BOARD APPEALS DATE:** September 13, 2016

REGARDING: 48975 GRAND RIVER AVE, PARCEL # 50-22-17-101-026
BY: Larry Butler, Deputy Director Community Development

I. GENERAL INFORMATION:

Applicant
GRAND PROMENADE LLC

Variance Type
SIGN VARIANCE

Property Characteristics
Zoning District: B-3 (GENERAL BUSINESS)
Location: SOUTH OF GRAND RIVER AVE AND EAST OF WIXOM ROAD
Parcel #: 50-22-17-101-026

Request
The applicant is requesting a variance from the CITY OF NOVI Code of Ordinances; Section 28-5(3) to allow construction of a second monument sign, of 30 square feet. This property is zoned B-3 (General Business).

II. STAFF COMMENTS:

Proposed Changes
A single sign is allowed by right for this new multi-tenant development.

III. RECOMMENDATION:

The Zoning Board of Appeals may take one of the following actions:

1. I move that we ***grant*** the variance in Case No. **PZ16-0034**, sought by _____, for _____ because Petitioner has shown practical difficulty requiring _____.
- (a) Without the variance Petitioner will be unreasonably prevented or limited with respect to use of the property because _____.
- (b) The property is unique because _____.

- (c) Petitioner did not create the condition because _____
_____.
- (d) The relief granted will not unreasonably interfere with adjacent or surrounding properties because _____
_____.
- (e) The relief is consistent with the spirit and intent of the ordinance because _____
_____.
- (f) The variance granted is subject to:
 - 1. _____.
 - 2. _____.
 - 3. _____.
 - 4. _____.

2. I move that we **deny** the variance in Case No. **PZ16-0034**, sought by _____,
for _____ because Petitioner has not shown
practical difficulty requiring _____.

- (a) The circumstances and features of the property including _____ are not unique because they exist generally throughout the City.
- (b) The circumstances and features of the property relating to the variance request are self-created because _____
_____.
- (c) The failure to grant relief will result in mere inconvenience or inability to attain higher economic or financial return based on Petitioner's statements that _____.
- (d) The variance would result in interference with the adjacent and surrounding properties by _____.
- (e) Granting the variance would be inconsistent with the spirit and intent of the ordinance to _____
_____.

Should you have any further questions with regards to the matter please feel free to contact me at (248) 347-0417.

Larry Butler
Deputy Director Community Development
City of Novi



45175 Ten Mile Road
 Novi, MI 48375
 (248) 347-0415 Phone
 (248) 735-5600 Facsimile
www.cityofnovi.org

ZONING BOARD OF APPEALS APPLICATION

APPLICATION MUST BE FILLED OUT COMPLETELY

I. PROPERTY INFORMATION (Address of subject ZBA Case)				Application Fee: _____	
PROJECT NAME / SUBDIVISION Grand Promenade				Meeting Date: _____	
ADDRESS 48975 Grand River		LOT/SIUTE/SPACE #		ZBA Case #: PZ _____	
SIDWELL # 50-22-17 - 101 - 026		May be obtain from Assessing Department (248) 347-0485			
CROSS ROADS OF PROPERTY South side of Grand River east of Wixom Road					
IS THE PROPERTY WITHIN A HOMEOWNER'S ASSOCIATION JURISDICTION? <input type="checkbox"/> YES <input checked="" type="checkbox"/> NO			REQUEST IS FOR: <input type="checkbox"/> RESIDENTIAL <input checked="" type="checkbox"/> COMMERCIAL <input type="checkbox"/> VACANT PROPERTY <input type="checkbox"/> SIGNAGE		
DOES YOUR APPEAL RESULT FROM A NOTICE OF VIOLATION OR CITATION ISSUED? <input type="checkbox"/> YES <input checked="" type="checkbox"/> NO					
II. APPLICANT INFORMATION					
A. APPLICANT		EMAIL ADDRESS georgepascaris@msn.com		CELL PHONE NO. 2482105522	
NAME George Pascaris				TELEPHONE NO.	
ORGANIZATION/COMPANY Grand Promenade LLC				FAX NO.	
ADDRESS 37660 Cherry Hill		CITY Farmington Hills		STATE MI	ZIP CODE 48331
B. PROPERTY OWNER <input checked="" type="checkbox"/> CHECK HERE IF APPLICANT IS ALSO THE PROPERTY OWNER					
Identify the person or organization that owns the subject property:		EMAIL ADDRESS		CELL PHONE NO.	
NAME				TELEPHONE NO.	
ORGANIZATION/COMPANY				FAX NO.	
ADDRESS		CITY		STATE	ZIP CODE
III. ZONING INFORMATION					
A. ZONING DISTRICT					
<input type="checkbox"/> R-A <input type="checkbox"/> R-1 <input type="checkbox"/> R-2 <input type="checkbox"/> R-3 <input type="checkbox"/> R-4 <input type="checkbox"/> RM-1 <input type="checkbox"/> RM-2 <input type="checkbox"/> MH <input type="checkbox"/> I-1 <input type="checkbox"/> I-2 <input type="checkbox"/> RC <input type="checkbox"/> TC <input type="checkbox"/> TC-1 <input checked="" type="checkbox"/> OTHER <u>B-3</u>					
B. VARIANCE REQUESTED					
INDICATE ORDINANCE SECTION (S) AND VARIANCE REQUESTED:					
1. Section _____ Variance requested _____					
2. Section _____ Variance requested _____					
3. Section _____ Variance requested _____					
4. Section _____ Variance requested _____					
IV. FEES AND DRAWINGS					
A. FEES					
<input type="checkbox"/> Single Family Residential (Existing) \$200 <input type="checkbox"/> (With Violation) \$250 <input type="checkbox"/> Single Family Residential (New) \$250					
<input type="checkbox"/> Multiple/Commercial/Industrial \$300 <input type="checkbox"/> (With Violation) \$400 <input checked="" type="checkbox"/> Signs \$300 <input type="checkbox"/> (With Violation) \$400					
<input type="checkbox"/> House Moves \$300 <input type="checkbox"/> Special Meetings (At discretion of Board) \$600					
B. DRAWINGS 1-COPY & 1 DIGITAL COPY SUBMITTED AS A PDF					
• Dimensioned Drawings and Plans			• Existing & proposed distance to adjacent property lines		
• Site/Plot Plan			• Location of existing & proposed signs, if applicable		
• Existing or proposed buildings or addition on the property			• Floor plans & elevations		
• Number & location of all on-site parking, if applicable			• Any other information relevant to the Variance application		



ZONING BOARD OF APPEALS APPLICATION

V. VARIANCE

A. VARIANCE (S) REQUESTED

DIMENSIONAL USE SIGN

There is a five-(5) hold period before work/action can be taken on variance approvals.

B. SIGN CASES (ONLY)

Your signature on this application indicates that you agree to install a **Mock-Up Sign ten-(10) days** before the schedule ZBA meeting. Failure to install a mock-up sign may result in your case not being heard by the Board, postponed to the next schedule ZBA meeting, or cancelled. A mock-up sign is **NOT** to be actual sign. Upon approval, the mock-up sign must be removed within five-(5) days of the meeting. If the case is denied, the applicant is responsible for all costs involved in the removal of the mock-up or actual sign (if erected under violation) within five-(5) days of the meeting.

C. ORDINANCE

City of Novi Ordinance, Section 3107 – Miscellaneous

No order of the Board permitting the erection of a building shall be valid for a period longer than one-(1) year, unless a building permit for such erection or alteration is obtained within such period and such erection or alteration is started and proceeds to completion in accordance with the terms of such permit.

No order of the Board permitting a use of a building or premises shall be valid for a period longer than one-hundred and eighty-(180) days unless such use is establish within such a period; provided, however, where such use permitted is dependent upon the erection or alteration or a building such order shall continue in force and effect if a building permit for such erection or alteration is obtained within one-(1) year and such erection or alteration is started and proceeds to completion in accordance with the terms of such permit.

D. APPEAL THE DETERMINATION OF THE BUILDING OFFICIAL

PLEASE TAKE NOTICE:

The undersigned hereby appeals the determination of the Building Official / Inspector or Ordinance made

CONSTRUCT NEW HOME/BUILDING ADDITION TO EXISTING HOME/BUILDING SIGNAGE
 ACCESSORY BUILDING USE OTHER _____

VI. APPLICANT & PROPERTY SIGNATURES

A. APPLICANT

Applicant Signature

Date

B. PROPERTY OWNER

If the applicant is not the owner, the property owner must read and sign below:

The undersigned affirms and acknowledges that he, she or they are the owner(s) of the property described in this application, and is/are aware of the contents of this application and related enclosures.

Property Owner Signature

Date

VII. FOR OFFICIAL USE ONLY

DECISION ON APPEAL:

GRANTED

DENIED

The Building Inspector is hereby directed to issue a permit to the Applicant upon the following and conditions:

Chairperson, Zoning Board of Appeals

Date



Community Development Department

45175 Ten Mile Road
Novi, MI 48375
(248) 347-0415 Phone
(248) 735-5600 Facsimile
www.cityofnovi.org

ZONING BOARD OF APPEALS VARIANCE APPLICATION CHECKLIST

The following items are required for a complete Variance application. Incomplete applications will be returned.

Signed Application Form

Complete the Zoning Board of Appeals application form. Application must be signed by the applicant and the property owner (if different).

Response to Variance Review Standards – Dimensional, Use, or Sign

Select the applicable Review Standards for the requested Variance and complete in full. Use additional paper if needed. If you don't know which Review Standards to complete, call the Community Development Department at 248.347.0415 for guidance.

Dimensioned Site Plan (1 copy & 1 digital copy submitted as a PDF)

- Existing or proposed buildings or additions on the property.
- Number and location of all on-site parking spaces.
- Existing and proposed distances to adjacent property lines.
- Location of existing and proposed signs, if applicable.
- Any other information relevant to the Variance application.

Dimensioned Drawings and Plans (1 copy & 1 digital copy submitted as a PDF)

- Floor plans and elevations with all proposed buildings and additions.
- All existing and proposed signs on the property (photographs may be used).
- For use variances, include floor plan showing the existing and proposed layout and functions of each area.
- For multi-family residential structures or projects, a summary showing the existing and proposed number of dwelling units by type (efficiency, one-bedroom, two-bedroom, etc.)

Other Helpful Information – Optional (1 copy & 1 digital copy submitted as a PDF)

- Photographs of the lot or structure that shows the special conditions or circumstances described in the application.
- Photographs or maps that show how other properties in the area enjoy the same type of property rights related to the Variance.
- Letters of support from the neighbors who would be most affected by your request.

Fee (make check payable to the City of Novi)

Single Family Residential (Existing) \$200 (With Violation) \$250
Single Family Residential (New) \$250
Multiple/Commercial/Industrial \$300 (With Violation) \$400
Signs \$300 (With Violation) \$400
House Moves \$300
Special Meetings (At discretion of Board) \$600

Additional Information

In the course of reviewing the application, the Planning Department staff may request additional information from the applicant.



Community Development Department

45175 Ten Mile Road
Novi, MI 48375
(248) 347-0415 Phone
(248) 735-5600 Facsimile
www.cityofnovi.org

**REVIEW STANDARDS
SIGN VARIANCE**

The Zoning Board of Appeals (ZBA) will review the application package and determine if the proposed Sign Variance meets the required standards for approval. In the space below, and on additional paper if necessary, explain how the proposed project meets each of the following standards. (Increased costs associated with complying with the Zoning Ordinance will not be considered a basis for granting a Sign Variance.)

Standard #1. Extraordinary Circumstances or Conditions.

Explain how the circumstances or physical conditions applying to the property that do not apply generally to other properties in the same Zone District or in the general vicinity. Circumstances or physical conditions may include:

- a. **Shape of Lot.** A sign could not be placed in the location required by the Zoning Ordinance due to the shape, topography or other physical conditions of the lot or due to the location of an existing structure.

Not Applicable Applicable If applicable, describe below:

and/or

- b. **Environmental Conditions.** A sign could not be placed in the location required by the Zoning Ordinance without removing or severely altering natural features, such as trees, topography, drainage courses or encroaching upon stormwater facilities.

Not Applicable Applicable If applicable, describe below:

and/or

- c. **Abutting Property.** A sign could not be reasonably seen by passing motorists due to the configuration of existing buildings, trees, signs or other obstructions on an abutting property.

Not Applicable Applicable If applicable, describe below:

d. **Scale of Building or Lot Frontage.** A sign that exceeds permitted dimensions for area and/or height could be considered appropriate in scale due to the length of the building frontage (wall sign only) or length of the lot frontage (ground sign only).

Not Applicable Applicable

If applicable, describe below:

e. **Not Self-Created.** Describe the immediate practical difficulty causing the need for the Variance was not created by the applicant or any person having an interest in the sign, sign structure, or property.

Not Applicable Applicable

If applicable, describe below:

There was a business center sign that was permitted at the Northwest corner of the subject property that serves a commercial development behind the subject property, it appears it was created when the roadway entering the property was established to identify the entrance for that development in the rear. That sign should not be allowed to interfere with our right and request to erect a sign that identifies the property and its address.

Standard #2. Limit Use of Property.

Explain how the failure to grant relief will unreasonably prevent or limit the use of the property and will result in substantially more than mere inconvenience or inability to attain a higher economic or financial return.

New retail development requesting to install a monument ground sign in front of the center to identify the center's location so the tenant's customers will be able to locate them. Not having the sign will make it difficult for passing motorists to locate their desired store.

Standard #3. Adverse Impact on Surrounding Area.

Explain how the Sign Variance will not result in a use or structure that is incompatible with or unreasonably interferes with adjacent or surrounding properties, will result in substantial justice being done to both the applicant and adjacent or surrounding properties, and is not inconsistent with the spirit and intent of this chapter.

Each property should be allowed to display a monument sign out front to advertise their address which helps motorists identify the location. Having a ground sign will help with traffic back ups and even accidents, this allows motorists to view the address in their site instead of trying to look at the building addresses while passing.

Parcels within 300' of 48975 Grand River Ave
City of Novi

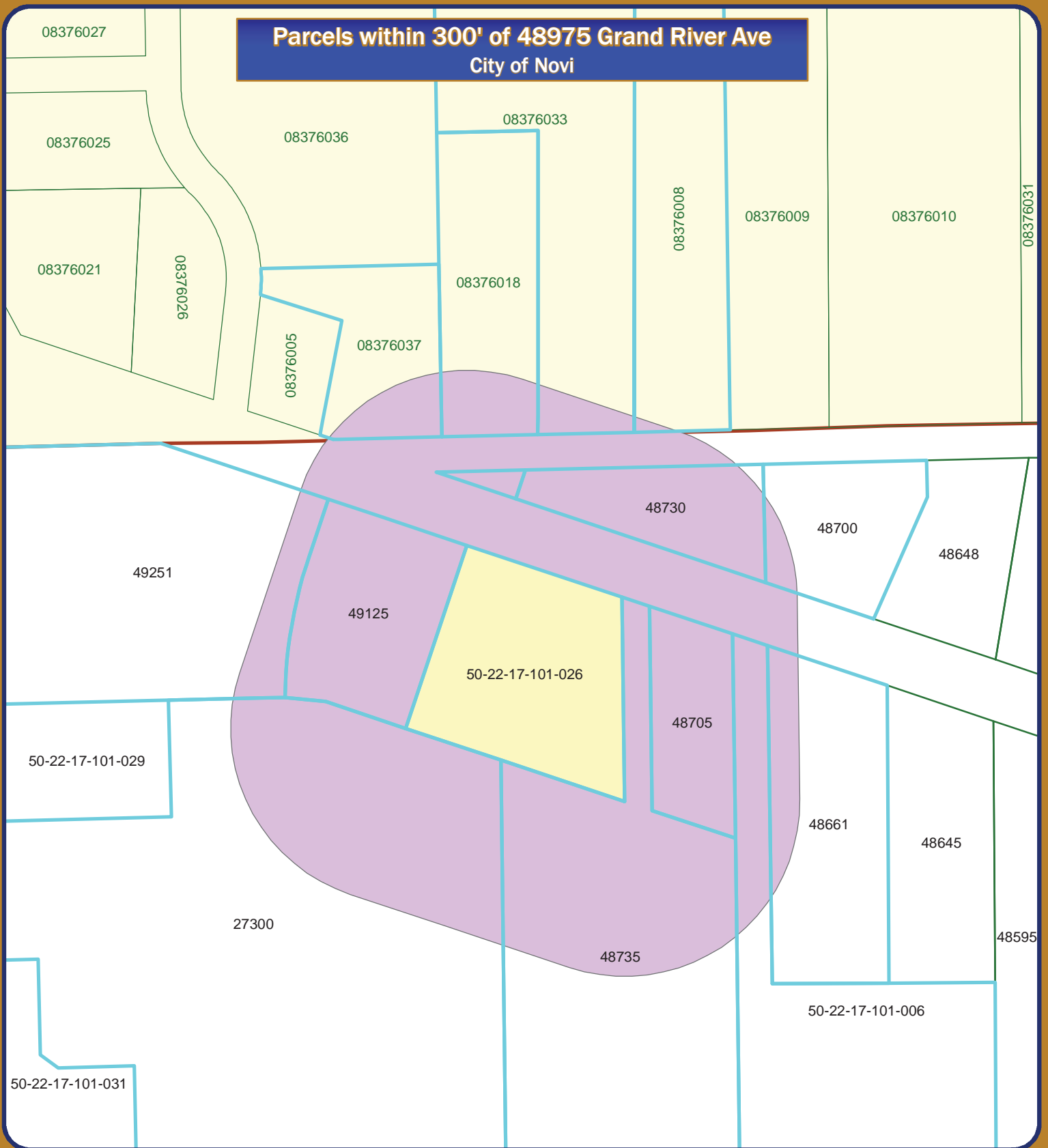

Map Author: Jon Gartha
Date: August 8, 2016
Address List for 50-22-17-101-026
Version #: 1.0

Amended By:
Date:
Department:

MAP INTERPRETATION NOTICE

Map information depicted is not intended to replace or substitute for any official or primary source. This map was intended to meet National Map Accuracy Standards and use the most recent, accurate sources available to the people of the City of Novi. Boundary measurements and area calculations are approximate and should not be construed as survey measurements performed by a licensed Michigan Surveyor as defined in Michigan Public Act 132 of 1970 as amended. Please contact the City GIS Manager to confirm source and accuracy information related to this map.

Map Legend

- 300' Buffer
 - Subject Property
 - Tax Parcel
- Municipality**
- Novi
 - Novi Twp.



City of Novi

IT Department
GIS Division
45175 Ten Mile Rd
Novi, MI 48375
cityofnovi.org



1 inch = 225 feet



TO: CITY OF NOVI
ZONING BOARD OF APPEALS
45175 TEN MILE ROAD
NOVI, MI 48375

Please note my comments to **48975 GRAND RIVER AVE (PZ16-0034)**

Please note my (Approval) (Objection) to the requested variance.

Comments:

(PLEASE PRINT CLEARLY) *Dan D. Valentine*

Name: DAN D. VALENTINE

Address: 48705 GRAND RIVER, NOVI, MI 48374

Date: AUG 26, 2016

Zoning Board of Appeals meetings are broadcast live on Bright House channel 13-1 and AT&T U-verse channel 99. They are also streamed live on the City's website at cityofnovi.org.

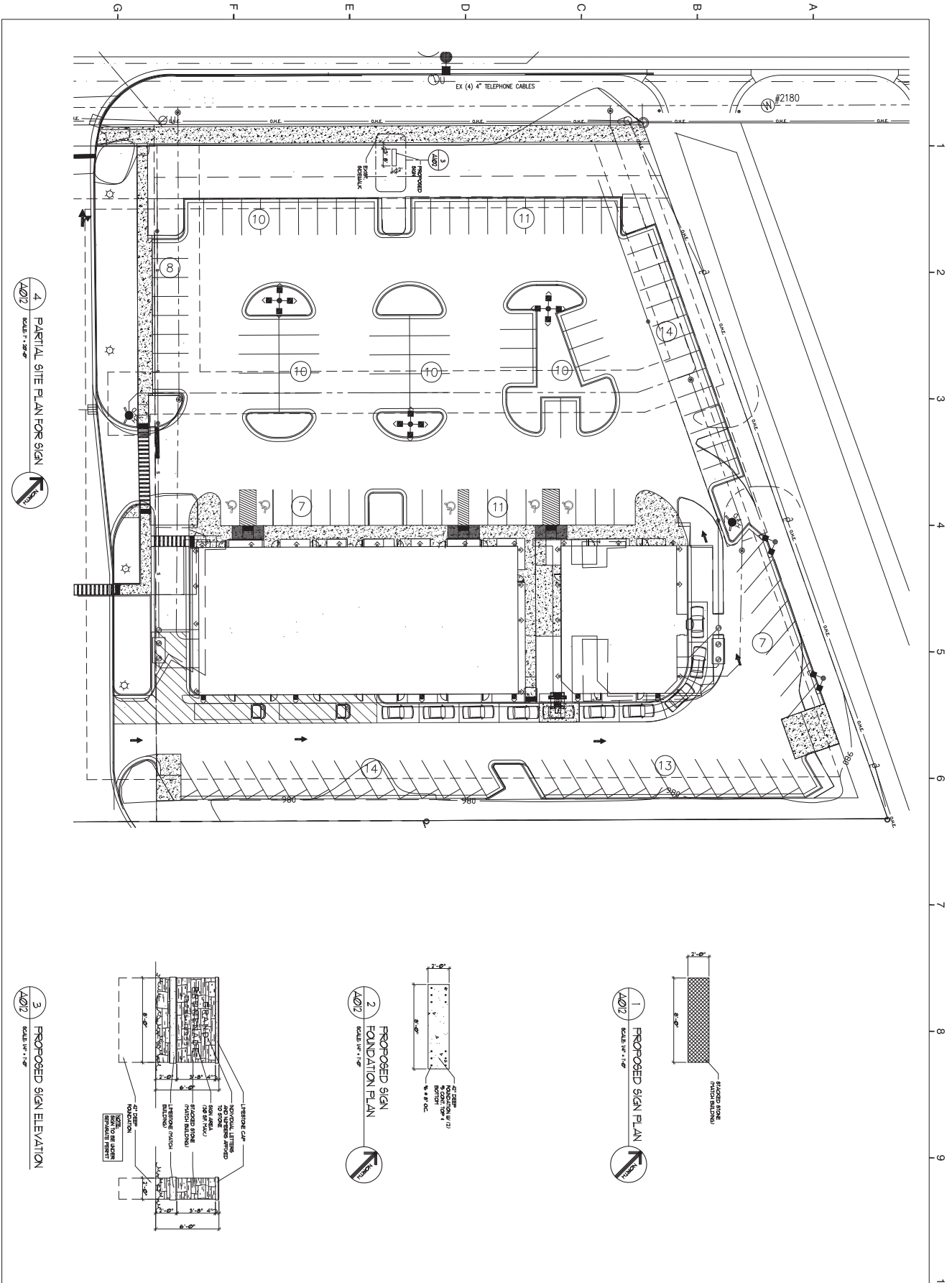

JOB NO. 14-0254	
ISSUANCES	
NO. DESCRIPTION	DATE BY
1 PERMIT SUBMISSION	01/27/15 WJW
2 PER CITY COMMENTS	03/03/15 WJW
3 VALUE ENGINEERING	10/22/15 WJW
4 REVISIONS	11/06/15 WJW
5 PER FIELD CONDITIONS	02/27/16 WJW
7 PER SIGN PERMIT	07/26/16 WJW

PROJECT NAME:
GRAND PROMENADE
RETAIL / COMMERCIAL
CENTER

FOR SIGN PERMIT
07-05-2016

ADDRESS:
48755 & 48955 GRAND RIVER
AVENUE
NOVI, MI 48374

DATE: 11/10/15

SCALE: 1/4" = 1'-0"

PROJECT NO. A0.1.2



FERRA - MARKO ASSOCIATES
ARCHITECTURAL DESIGNERS
189 E Big Beaver, Suite 106 Troy, MI 48063
Tel: 248.457.6903 Fax: 248.457.6906
Email: info@s-m-associates.com
Website: www.s-m-associates.com