



CITY of NOVI CITY COUNCIL

www.cityofnovi.org

Agenda Item G
February 12, 2007

SUBJECT: Approval of the final balancing change order and final payment to Hard Rock Concrete, Inc. for the 2006 Neighborhood Concrete Street Reconstruction project in the amount of \$78,273.46.

SUBMITTING DEPARTMENT: Engineering *RA*

CITY MANAGER APPROVAL: *[Signature]*

EXPENDITURE REQUIRED	N/A
AMOUNT BUDGETED	N/A
APPROPRIATION REQUIRED	N/A
LINE ITEM NUMBER	N/A

BACKGROUND INFORMATION:

The City's consulting engineer for this project (Fishbeck, Thompson, Carr & Huber) administered the construction contract for reconstructing several concrete streets in the city in 2006. Fishbeck has executed and submitted the attached documents verifying the final contract payment amount that is due to the construction contractor, Hard Rock Concrete, Inc. of Westland, MI (Fishbeck's Final Pay Estimate No. 6 and Balancing Change Order, attached).

The concrete street reconstruction work performed by the contractor has been in substantial compliance with the plans and specifications, and final payment in the amount of \$78,273.46 is appropriate. In addition, the City Attorney has reviewed supporting documentation and found it to be in an acceptable form. The original contract was approved at the July 24, 2006 City Council meeting in the amount of \$939,560.00. The final payment brings the total in construction expenditures on this project to \$956,962.88.

In little more than two months, Hard Rock Concrete completed 1.63 miles of concrete street reconstruction, including Argyle Street, Davenport Avenue, Amherst Drive, Chesterfield Court, Picadilly Drive, Picadilly Circle, and the boulevard entrance to Windridge Lane. In addition, Hard Rock completed extensive sidewalk and curb/gutter replacement at the Civic Center in advance of Fall for Novi festivities held on September 23, 2006. (The attached map depicts these areas, as well as the asphalt streets completed under a separate contract in 2006.)

RECOMMENDED ACTION: Approval of the final balancing change order and final payment to Hard Rock Concrete, Inc. for the 2006 Neighborhood Concrete Street Reconstruction project in the amount of \$78,273.46

	1	2	Y	N
Mayor Landry				
Mayor Pro Tem Capello				
Council Member Gatt				
Council Member Margolis				

	1	2	Y	N
Council Member Mutch				
Council Member Nagy				
Council Member Paul				

Client: City of Novi
 Project: 2006 Neighborhood Roads Program, Concrete - G06319AC
 Contractor: Hard Rock Concrete, Inc.

Pay Estimate No.: 6
 Period: 10/28/06 - 12/8/06
 Progress or Final: Final payment

Item No.	Item Description	Unit	Original Authorized Quantity	Final Authorized Quantity	Unit Price	Quantity This Estimate	Amount This Estimate	Quantity Previously Paid	Quantity Paid to Date	Total Amount Earned to Date
Base Bid - Argyle, Windridge, Davenport, Amherst										
1	Pre-Construction Audio-Visual	LS	1.0	1.0	\$250.00		\$ -	1.0	1.0	\$ 250.00
2	Soil Erosion Control	LS	1.0	1.0	\$500.00		\$ -	1.0	1.0	\$ 500.00
3	Maintaining Traffic	LS	1.0	1.0	\$500.00		\$ -	1.0	1.0	\$ 500.00
4	Tree Protection	Ea	128.0		\$20.00		\$ -			\$ -
5	Remove Concrete Pavement	Syd	12440.0	12209.6	\$3.00		\$ -	12,209.6	12,209.6	\$ 36,628.74
6	Underdrain, 4-inch	Ft	7060.0	6901.9	\$5.00		\$ -	6,901.9	6,901.9	\$ 34,509.50
7	Subgrade Undercut	Cyd	140.0	239.0	\$15.00	133.34	\$ 2,000.10	105.7	239.0	\$ 3,585.60
8	Aggregate Base, 21AA, 8-inch	Syd	12440.0	12209.6	\$4.00		\$ -	12,209.6	12,209.6	\$ 48,838.32
9	Concrete Pavement w/Integral Curb, Non-reinf, 7-inch	Syd	12440.0	12209.6	\$26.00		\$ -	12,209.6	12,209.6	\$ 317,449.08
10	Remove and Replace Concrete Drives	Syd	1110.0	1050.6	\$27.00		\$ -	1,050.6	1,050.6	\$ 28,368.17
11	Remove and Replace Concrete Sidewalk	Sft	250.0	547.4	\$4.00	297.43	\$ 1,189.72	250.0	547.4	\$ 2,189.72
12	Adjust Drainage Structure	Ea	20.0		\$275.00		\$ -			\$ -
13	Remove and Reset Mailboxes	Ea	26.0	33.0	\$10.00		\$ -	33.0	33.0	\$ 330.00
14	Remove and Reset Sprinkler Heads	Ea	68.0		\$10.00		\$ -			\$ -
15	Sprinkler Piping	Ft	570.0		\$0.40		\$ -			\$ -
16	Class A Sod	Syd	1290.0	250.0	\$6.00		\$ -	250.0	250.0	\$ 1,500.00
17	ADA Detectable Warning Plate - New Construction	Sft	40.0	40.0	\$20.00		\$ -	40.0	40.0	\$ 800.00
Alternative 1 - Chesterfield Court										
1	Pre-Construction Audio-Visual	LS	1.0	1.0	\$250.00		\$ -	1.0	1.0	\$ 250.00
2	Soil Erosion Control	LS	1.0	1.0	\$500.00		\$ -	1.0	1.0	\$ 500.00
3	Maintaining Traffic	LS	1.0	1.0	\$500.00		\$ -	1.0	1.0	\$ 500.00
4	Tree Protection	Ea	33.0	0.0	\$20.00		\$ -			\$ -
5	Remove Concrete Pavement	Syd	2980.0	3086.2	\$3.00		\$ -	3,086.2	3,086.2	\$ 9,258.62
6	Underdrain, 4-inch	Ft	1506.0	1469.3	\$5.00		\$ -	1,469.3	1,469.3	\$ 7,346.50
7	Subgrade Undercut	Cyd	26.0	0.0	\$16.00		\$ -			\$ -
8	Aggregate Base, 21AA, 8-inch	Syd	2980.0	3086.2	\$4.00		\$ -	3,086.2	3,086.2	\$ 12,344.84
9	Concrete Pavement w/Integral Curb, Non-reinf, 7-inch	Syd	2980.0	3086.2	\$26.00		\$ -	3,086.2	3,086.2	\$ 80,241.46
10	Remove and Replace Concrete Drives	Syd	280.0	312.8	\$27.00		\$ -	312.8	312.8	\$ 8,445.08
11	Remove and Replace Concrete Sidewalk	Sft		182.0	\$4.00	182.00	\$ 728.00		182.0	\$ 728.00
12	Adjust Drainage Structure	Ea	4.0	0.0	\$275.00		\$ -			\$ -
13	Remove and Reset Mailboxes	Ea	7.0	0.0	\$10.00		\$ -			\$ -
14	Remove and Reset Sprinkler Heads	Ea	3.0	0.0	\$10.00		\$ -			\$ -
15	Sprinkler Piping	Ft	24.0	0.0	\$0.40		\$ -			\$ -
16	Class A Sod	Syd	280.0	0.0	\$6.00		\$ -			\$ -
17	ADA Detectable Warning Plate - New Construction	Sft		16.0	\$20.00	16.00	\$ 320.00		16.0	\$ 320.00
Alternative 2 - Picadilly Circle										
1	Pre-Construction Audio-Visual	LS	1.0	1.0	\$250.00		\$ -	1.0	1.0	\$ 250.00
2	Soil Erosion Control	LS	1.0	1.0	\$500.00		\$ -	1.0	1.0	\$ 500.00
3	Maintaining Traffic	LS	1.0	1.0	\$500.00		\$ -	1.0	1.0	\$ 500.00
4	Tree Protection	Ea	89.0		\$20.00		\$ -			\$ -
5	Remove Concrete Pavement	Syd	5000.0	4323.9	\$3.00		\$ -	4,323.9	4,323.9	\$ 12,971.76
6	Underdrain, 4-inch	Ft	2719.0	2164.0	\$5.00		\$ -	2,164.0	2,164.0	\$ 10,820.00
7	Subgrade Undercut	Cyd	50.0		\$15.00		\$ -			\$ -
8	Aggregate Base, 21AA, 8-inch	Syd	5000.0	4323.9	\$4.00		\$ -	4,323.9	4,323.9	\$ 17,295.68
9	Concrete Pavement w/Integral Curb, Non-reinf, 7-inch	Syd	5000.0	4323.9	\$26.00		\$ -	4,323.9	4,323.9	\$ 112,421.82
10	Remove and Replace Concrete Drives	Syd	565.0	427.6	\$27.00		\$ -	427.6	427.6	\$ 11,544.39
11	Remove and Replace Concrete Sidewalk	Sft		82.5	\$4.00	82.50	\$ 330.00		82.5	\$ 330.00
12	Adjust Drainage Structure	Ea	4.0		\$275.00		\$ -			\$ -
13	Remove and Reset Mailboxes	Ea	9.0	9.0	\$10.00	9.00	\$ 90.00		9.0	\$ 90.00
14	Remove and Reset Sprinkler Heads	Ea	11.0		\$10.00		\$ -			\$ -
15	Sprinkler Piping	Ft	128.0		\$0.40		\$ -			\$ -
16	Class A Sod	Syd	550.0		\$6.00		\$ -			\$ -
17	ADA Detectable Warning Plate - New Construction	Sft			\$20.00		\$ -			\$ -

Item No.	Item Description	Unit	Original Authorized Quantity	Final Authorized Quantity	Unit Price	Quantity This Estimate	Amount This Estimate	Quantity Paid	Quantity Paid to Date	Total Amount Earned to Date
Alternative 3 - Picadilly Drive										
1	Pre-Construction Audio-Visual	LS	1.0	1.0	\$250.00		\$ -	1.0	1.0	\$ 250.00
2	Soil Erosion Control	LS	1.0	1.0	\$500.00		\$ -	1.0	1.0	\$ 500.00
3	Maintaining Traffic	LS	1.0	1.0	\$500.00		\$ -	1.0	1.0	\$ 500.00
4	Tree Protection	Ea	37.0		\$20.00		\$ -			\$ -
5	Remove Concrete Pavement	Syd	2740.0	3264.6	\$3.00		\$ -	3,264.6	3,264.6	\$ 9,793.85
6	Underdrain, 4-inch	Ft	1734.0	2080.0	\$5.00		\$ -	2,080.0	2,080.0	\$ 10,400.00
7	Subgrade Undercut	Cyd	35.0		\$15.00		\$ -			\$ -
8	Aggregate Base, 21AA, 8-inch	Syd	2740.0	3264.6	\$4.00		\$ -	3,264.6	3,264.6	\$ 13,058.20
9	Concrete Pavement w/Integral Curb, Non-reinf, 7-inch	Syd	2740.0	3264.6	\$26.00		\$ -	3,264.6	3,264.6	\$ 84,878.30
10	Remove and Replace Concrete Drives	Syd	280.0	395.8	\$27.00		\$ -	395.8	395.8	\$ 10,685.52
11	Remove and Replace Concrete Sidewalk	Sft		197.9	\$4.00	197.92	\$ 791.68		197.9	\$ 791.68
12	Adjust Drainage Structure	Ea	7.0		\$275.00		\$ -			\$ -
13	Remove and Reset Mailboxes	Ea	5.0	5.0	\$10.00	5.00	\$ 50.00		5.0	\$ 50.00
14	Remove and Reset Sprinkler Heads	Ea	5.0	0.0	\$10.00		\$ -			\$ -
15	Sprinkler Piping	Ft	43.0	0.0	\$0.40		\$ -			\$ -
16	Class A Sod	Syd	340.0	139.7	\$6.00	139.67	\$ 838.02		139.7	\$ 838.02
17	ADA Detectable Warning Plate - New Construction	Sft			\$20.00	24.00	\$ 480.00		24.0	\$ 480.00
Alternative 4 - Civic Center										
18	Curb and Gutter removal and replacement	LF	420.0	420.0	\$20.00		\$ -	420.0	420.0	\$ 8,400.00
CM#2	Curb and Gutter removal and replacement	LF		830.0	\$20.00	16.00	\$ 320.00	830.0	846.0	\$ 16,920.00
CM#2	ADA Detectable Warning Plate - New Construction	Sft		96.0	\$20.00		\$ -	96.0	96.0	\$ 1,920.00
CM#2	Adjust Drainage Structure	Ea		1.0	\$275.00		\$ -			\$ -
CM#2	Remove and Replace Concrete Sidewalk	Sft		3050.0	\$4.00	3.05	\$ 12.20	3,050.0	3,053.1	\$ 12,212.20
Extra Items										
CM#1	Road Commission Oakland County Permit & Fees	Dtr		1.0	\$640.00		\$ -	1.0	1.0	\$ 640.00
CM#3	Catch Basin, Point and Reconstruct, 1-foot	Ea		33.0	\$350.00	33.00	\$ 11,550.00		33.0	\$ 11,550.00
CM#3	Catch Basin, Reconstruction more than 1-foot (vertical)	Ea		1.0	\$150.00	1.00	\$ 150.00		1.0	\$ 150.00
CM#3	Slope Restoration	Sft		13014.0	\$0.71	13,014.00	\$ 9,239.94		13,014.0	\$ 9,239.94
CM#3	Dr Structure Cover EJJW 7045	Ea		4.0	\$400.00	4.00	\$ 1,600.00		4.0	\$ 1,600.00

Current Earnings: \$29,689.66 Total Earnings: \$956,962.88
 - Current Retainage: -\$48,583.80 -Retainage to Date: \$0.00
 - Current Retainage Adjustments: \$0.00 -Adjustments to Date: \$0.00
 Current Net Estimate: \$78,273.46 Total Net: \$ 856,962.88

Amount Due This Estimate: \$ 78,273.46

OK
 Rthg 1/19/07

I certify that the items included on this report constitute my estimate of the work completed and due the contractor as of the period covered by this document.

Karen E Ellis
 Ms. Karen E. Ellis, P.E. - Project Engineer

I have reviewed this estimate on behalf of Hard Rock Concrete, Inc. and concur with the quantities presented for the period covered by this document.

Rob Hayes
 authorized signature
 Printed Name: Rob Hayes

Contract Summary
 Amount Previously Paid: \$878,589.42
 Total Paid: \$956,952.88
 Original Contract: \$940,041.00
 CM#1 \$640.00
 CM#2 \$30,995.00
 CM#3 -\$14,713.12
 Total Contract Amount \$956,962.88
 % of Original 101.8%
 Percentage of Contract Completed: 100%

Location Map

2006 Neighborhood Street Program

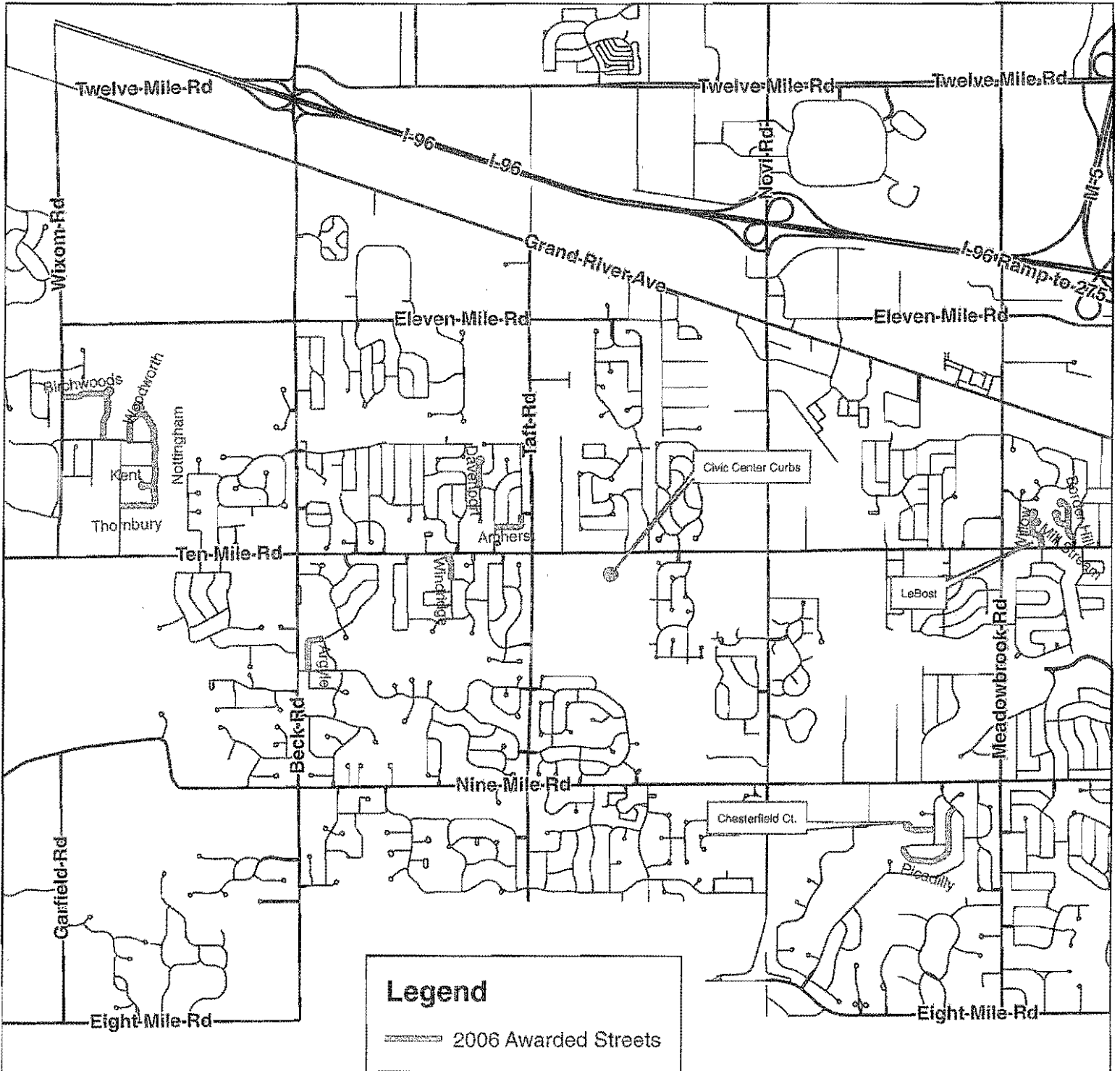

CITY OF NOVI
GEOGRAPHIC INFORMATION SYSTEMS OFFICE
DEPARTMENT OF INFORMATION TECHNOLOGY
NOVI CITY HALL/CIVIC CENTER
45175 W. TWIN MILE ROAD
NOVI, MI 48375-3024
(313) 347-3279
WWW.CITYOFNOVI.MI.US

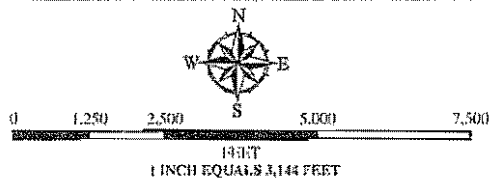

MAP INTERPRETATION NOTICE
Map information depicted is not intended to replace or substitute for any official or primary source. This map was intended to meet National Map Accuracy Standards and use the most recent, accurate sources available to the people of the City of Novi. Boundary measurements and area calculations are approximate and should not be construed as survey measurements performed by a licensed Michigan Surveyor as defined in Michigan Public Act 132 of 1970 as amended. Please contact the City GIS Manager to confirm source and accuracy information related to this map.